

Scale 20 chains

1/4 inch

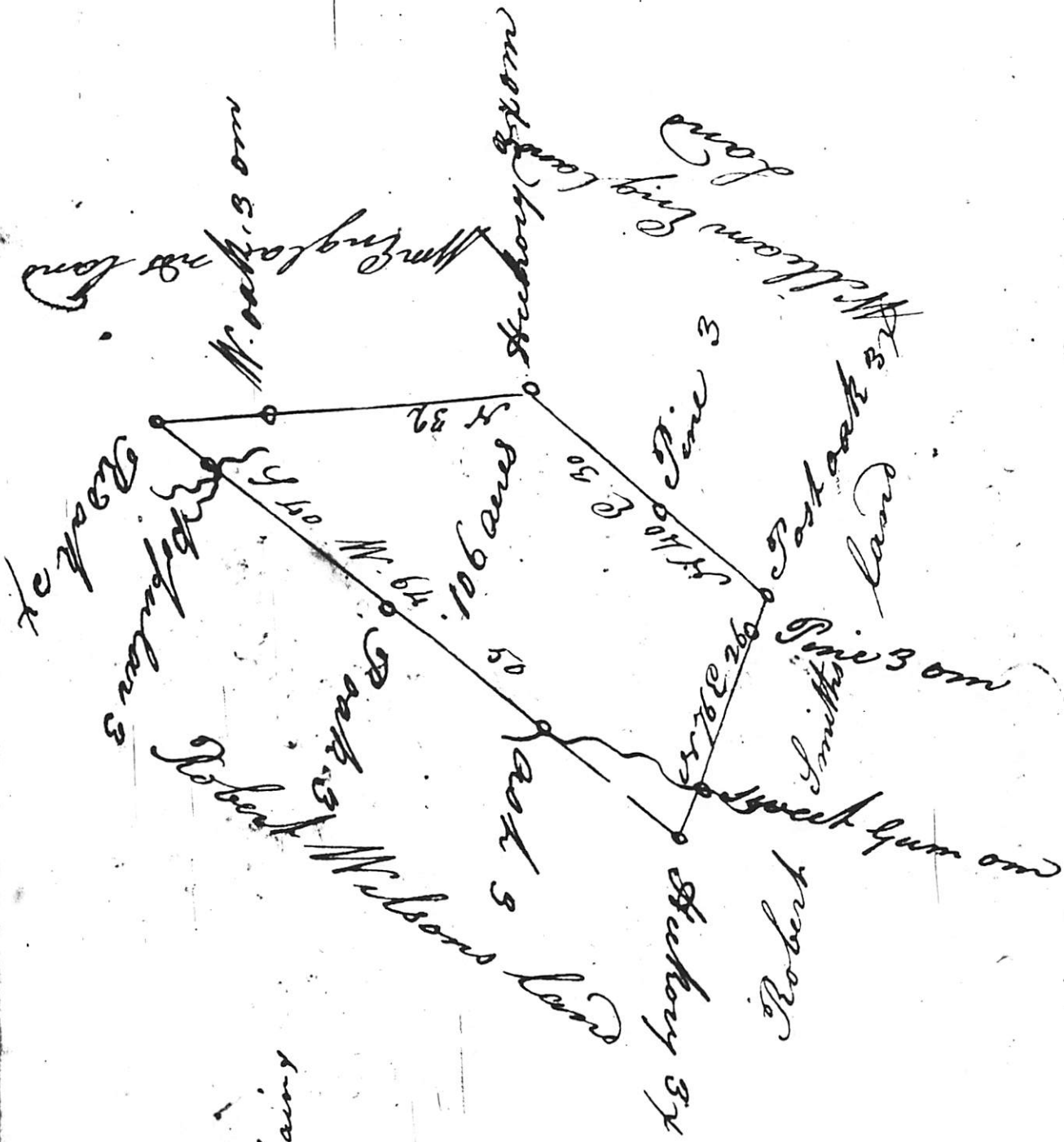

State of South Carolina

Whereas a warrant from John

David Reed Esqrs Comr of dock I have administered and

laid out unto James Barber a plantation or tract of land

containing one hundred and six Acs situated on the flays

Branch the waters of the water creek in Fairfield County

of Camden District & bounded on the NW part on Robt

Wilson's land and on the NE part on Wm England's land

and on the SE part on William England's land and half

such Rope for my and Mary's as the above platte represents

certified by me this 12<sup>th</sup> Day of Sept<sup>r</sup> 1795

And<sup>th</sup> M Dourle D<sup>r</sup>

Recorded & D<sup>d</sup> James Barber 3 Oct<sup>r</sup> 1795